

**ADJUSTABLE REAR LOWERING KIT YAMAHA
ROADSTAR/WARRIOR**

Revision: 1.0 - 02/22/2010

CAUTION! We Strongly recommend that a qualified technician install this kit if you do not completely understand the instructions prior to the install.**INCLUDED IN THE KIT:**

(2) Zinc Machined Hex Shaft	(2) 1/2-20 Zinc Left Hand Jam Nuts
(1) Machined Spacer	(4) 1/2-20 Zinc Jam Nuts
(1) 12mm x1.75 x 140mm Hex Bolt	(2) 1/2-20 Zinc Female Rod Ends
(1) 12mm x 1.75 Nylock Nut	(2) 1/2 -20 Zinc Male Rod Ends
(2) 1/2-20x 7" Zinc Double Ended Stud	

TOOLS REQUIRED:

Factory Service Manual	Pliers (std. & needle nose)
Phillips & Flat Screwdrivers	10mm Open End Wrench
10 & 12 mm Sockets	3, 4, & 5 mm Allen Wrenches

INSTRUCTIONS:

1. Secure motorcycle to a bike lift and raise the motorcycle. Rear wheel should remain barely resting on the ground.
2. See diagram on page 2 for references made in parentheses, for example (#5).
3. Remove the nut from the rear suspension bolt (#5) at the bottom of the shock (#7). You may need to remove your exhaust and rear horn to access the nut and bolt.
4. Remove this suspension bolt (#5) from the non-exhaust side of the bike. You may need to raise or lower the bike to ease the tension on the bolt in order for it to come out.
5. Next remove the nut (#4) and bolt connecting the relay arm (#3) to the swingarm. From here remove the entire shock assembly and relay arm from the bike. For ease of re-installing the relay arm (Step 8) and shock be sure to take precautions that in removing the assembly, you can put it back the same way you took it off. Flipping of the relay arm can cause serious damage to the lowering kit and surrounding components.
6. Remove the two suspension arms from the relay arm(#3) and shock(#7). Compare stock arm to length of lowering arm you are about to install. Make sure the length of the lowering arm matches the link of the stock arm. To set how much you want to lower the bike, lengthen the lowering arms. Every 1/4" longer than stock is approximately 1" of drop. Do not lower the bike more than 2" for safety reasons. To adjust, unscrew the large hex shaft from the threaded rods. Make sure to adjust length equally on both shafts. Be sure to tighten all jam nuts once desired lowering position is set.
7. Re-assemble the lowering arms to the top of the shock (#7) using the supplied collar, nut, and bolt. The stock collar (#6), the one in the eyelet at the top of the shock (#7), will need to be removed as it is too long. (This is because the heims are thicker than the stock arms) Do not tighten the nut, or re-install into the frame yet.
8. Re-install the relay arm (#3) to the swingarm. The large hex shafts go to the rear of the bike. This is where it

Our install guides provide a basic outline on the proper installation of our products. Further tuning and/or fitment may be required. Barons bears no responsibility on installation costs associated with this product.

© 2025 Barons Custom Accessories

**ADJUSTABLE REAR LOWERING KIT YAMAHA
ROADSTAR/WARRIOR**

is critical to make sure the orientation of the relay arm is the same as you removed it in step 4, so as not to cause potential damage or harm.

9. Re-install the shock back onto the frame and tighten all nuts and bolts. Lower bike from lift and check lowered height. If adjustment is required, you must repeat all the steps and adjust as necessary in Step 5. Once everything is set installation is complete. If the exhaust and/or horn was removed, it should now be re-installed.

NOTE: We recommend that you set the shock spring preload to a higher setting, especially if the motorcycle will be used for carrying a passenger or heavy loads. We recommend the purchase and installation of the Baron Heavy Duty Shock Spring for use on lowered Yamaha Warriors.

WARNING: Installing a lowering kit will decrease initial ground clearance. The motorcycle will be lower to the ground and care should be taken to avoid bottoming, especially over bumps or in turns. To maintain proper balanced geometry, the front and rear of the motorcycle should be lowered equally. Failure to properly install the lowering kit and operate the motorcycle after installation may result in serious injury or death to the rider.

LIMITED GUARANTEE: Because we cannot control the application of our products, buyer assumes risks for any and all damage caused to him or herself or any third party by virtue of any failure of these parts. Guarantee for such parts is limited to our replacement costs thereof. This guarantee is in lieu of all other guarantees or warranties express or implied, and all other such guarantees or warranties are hereby expressly disclaimed. By installation of these irrevocably agrees to i parts, buyer the foregoing.

Our install guides provide a basic outline on the proper installation of our products. Further tuning and/or fitment may be required. Barons bears no responsibility on installation costs associated with this product.
© 2025 Barons Custom Accessories

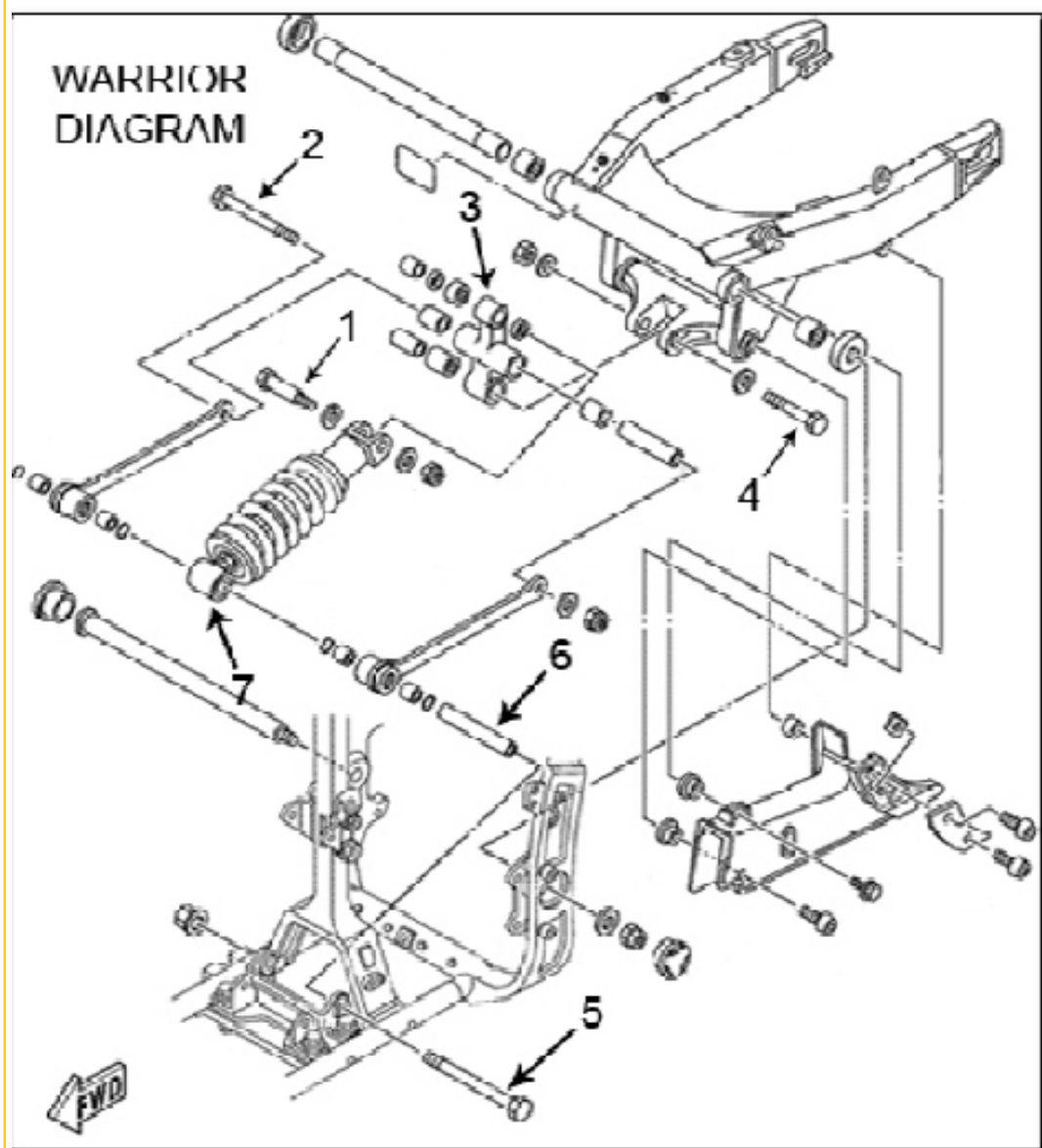

Our install guides provide a basic outline on the proper installation of our products. Further tuning and/or fitment may be required. Barons bears no responsibility on installation costs associated with this product.
© 2025 Barons Custom Accessories